



1840 NW 118th Street, Suite 100
Clive, Iowa 50325
Telephone: 515-440.0400
Fax: 515.440.0500

FOR SALE



PRICE REDUCED

**1200 SW Brookside Circle
Grimes, IA 50111**

General Use: Light Industrial
Available: 1,400 – 6,800 S.F.
Sale Price: \$104,900 per bay

Highlights:

- 1 - 14' x 16' drive-in door per bay
- 30' x 60' bays
- 20' clear height
- Sprinklered
- M-2 zoning
- Easy access to Hwy 141 & I-80/35
- **Preferred Lender Available**

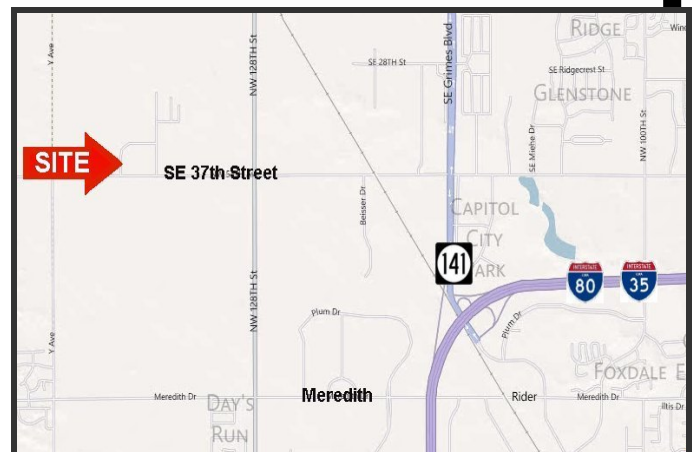

For additional information please contact:
Andy Sass / andy@fergusoncres.com
Aaron A. Hyde / aaron@fergusoncres.com
Darin E. Ferguson / darin@fergusoncres.com

**Partner with the
Proven Winner**

The above information has been obtained from the property owner or other sources that we deem reliable. Although we have no reason to doubt its accuracy or completeness, no representation or warranty is made regarding the property is offered "as is". This submission may be modified or withdrawn at any time by the property.

BUILDING SITE



Available Suites

Suite 9	1,800 S.F.
Suite 11	1,800 S.F.
Suite 12	1,800 S.F.
Suite 13	1,800 S.F.
Suite 14	1,800 S.F.
Suite 16	1,800 S.F.
Suite 17	1,400 S.F.
Suite 18	1,800 S.F.
Suite 19	1,800 S.F.
Suite 20	1,800 S.F.

For additional information please contact:

Andy Sass / andy@fergusoncrs.com

Aaron A. Hyde / aaron@fergusoncrs.com

Darin E. Ferguson / darin@fergusoncrs.com

Partner with the
Proven Winner